

GRAND ELEGANCE

INSTALLATION INSTRUCTIONS



WIRING INSTRUCTIONS

LICENSED ELECTRICIAN

For safety reasons, it is recommended to have a licensed electrician install the wiring of Grand Elegance power blinds.

APPLICATION

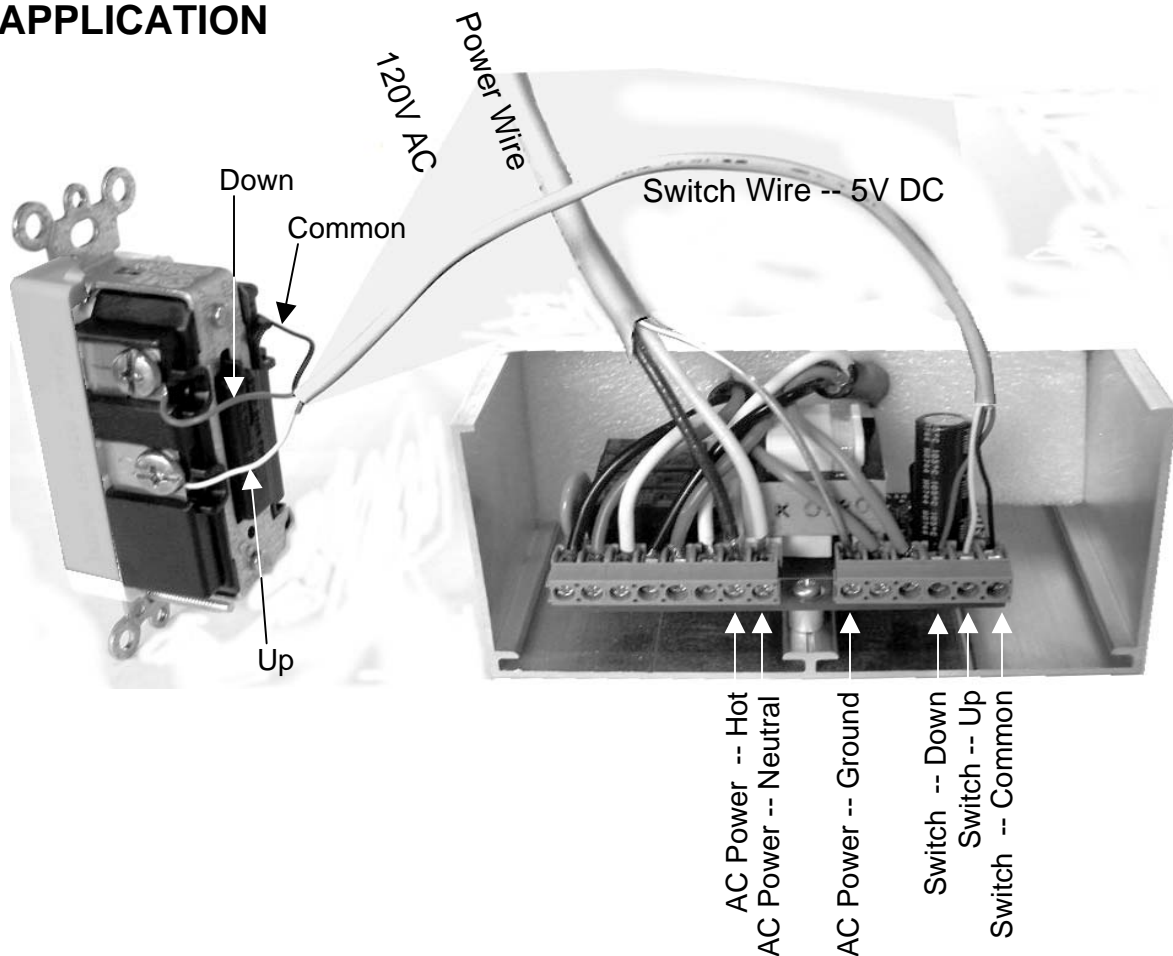

WIRING CONNECTORS

Wires can be easily connected with convenient screw-in sockets. Please ensure that all wires are screwed in securely.

RECOMMENDED WIRE SIZES

The recommended wire size for the power wire is 12-16 gauge.

-- 14 gauge power wire is typical

The recommended wire size for the switch wire is 12-26 gauge.

-- 18-22 gauge wire is typical

ADJUSTING THE LIMIT SWITCHES

CAUTION

The limit switches have been pre-set at the factory and should not require adjustment. Nevertheless, instructions for adjusting the limit switches are detailed below. **Warning: Adjusting the limit switches is not recommended and should be done with extreme caution. Permanent damage to the blind, and physical injury can occur. Damage that occurs as a result of mis-adjusting the limit switches will void the warranty.**

LIMIT SWITCH ADJUSTMENTS

Grand Elegance motorized blinds have 4 limit settings that are set by adjusting the limit switch screw at the bottom of the headrail:

- 1) Upper Lift Limit -- the maximum height that the motor will lift the slats.
- 2) Lower Lift Limit -- the maximum position to which the motor will lower the slats.
- 3) Forward Tilt Limit -- the maximum angle that the motor will tilt the slats in the forward direction.
- 4) Backward Tilt Limit -- the maximum angle that the motor will tilt the slats in the backward direction.

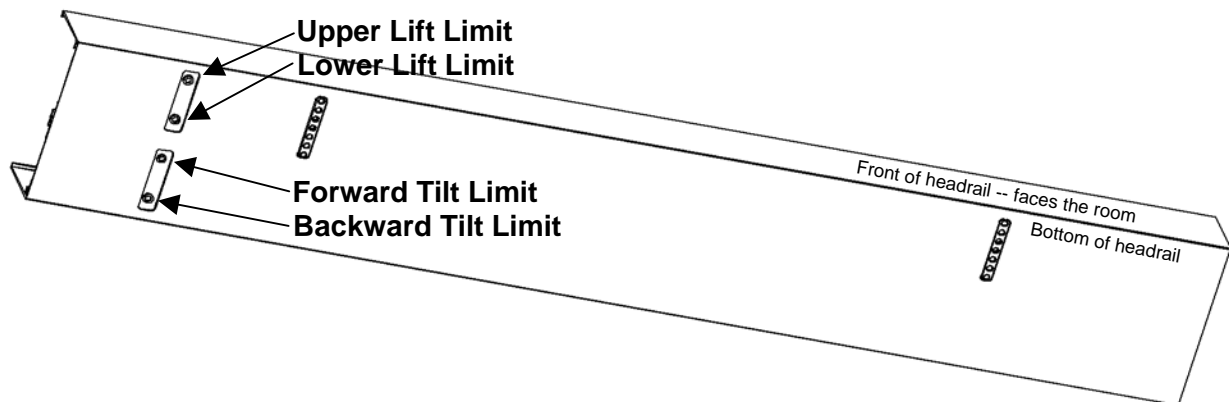

ADJUSTING THE LIMIT SWITCHES

To adjust the limit switches, use the limit switch adjustment tool.

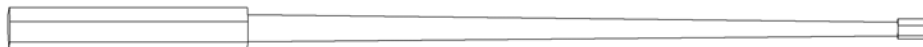

Rotating the adjustment screw clockwise increases the travel limit. Rotating the adjustment screw counterclockwise decreases the travel limit.

OPERATING THE BLIND

GRAND ELEGANCE OPERATING INSTRUCTIONS

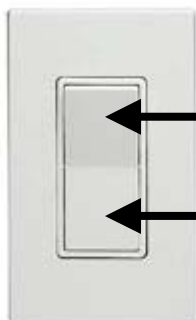

TAP -- to lift slats to the top
HOLD -- to tilt slats backward

TAP -- to lift slats to the top
TAP TWICE -- to lower and leave slats tilted open
HOLD -- to tilt slats backward



Tap Once

Open Blind: Tap the top side of the switch once.

The blinds will tilt open, then rise to the top. Upon reaching the top they will automatically stop.



Tap Once

Close Blind: Tap the bottom side of the switch once.

The blinds will lower all the way down. Upon reaching the bottom the slats will tilt closed.*



Press and Hold

Tilt Slats Forward: Press and hold the bottom side of the switch.

The slats will tilt forward. They will continue to tilt forward until you release.



Press and Hold

Tilt Slats Backward: Press and hold the top side of the switch.

The slats will tilt backwards. They will continue to tilt backwards until you release.



Tap Twice

Lower Blind with Slats in Preferred Position:** Tap the bottom of the switch once.

*The blinds will lower all the way down. Upon reaching the bottom the slats will tilt to the preferred position**.*



Tap

OR



Tap

Stop Any Operation in Progress: Tap either side of the switch again

The slats will immediate stop.

* Note: To select which direction the slats will tilt closed, see "Programming the Closed Position".

** Note: To program your preferred position, see "Programming the Preferred Position".

PROGRAMMING THE PREFERRED POSITION

ABOUT THE PREFERRED POSITION

The Preferred Position is the angle that the slats will tilt to following a double-tap on the down-side of the switch.

PROGRAMMING THE PREFERRED POSITION -- STEP 1

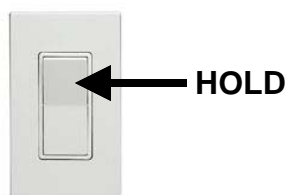

OR

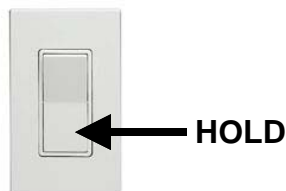

First move the slats to your Preferred Position. This is accomplished by pressing and holding the top, or pressing and holding the bottom of the switch until the slats reach the angle that you would like to program to be the Preferred Position.

PROGRAMMING THE PREFERRED POSITION -- STEP 2



Press and hold the top of the switch for ten seconds. The slats may move while you continue to press the switch. Continue to press for a full ten seconds.

When you release the blinds will wiggle. The wiggle indicates that the new Preferred Position has been successfully programmed.

PROGRAMMING THE CLOSED POSITION

PROGRAMMING THE CLOSED POSITION

The closed position is the angle that the slats will tilt to following a single-tap on the down side of the switch. The Closed Position can be programmed so that the slats either tilt all the way forward, or all the way backward when the blinds are closed.

ABOUT PROGRAMMING THE CLOSED POSITION

The “closed” position can be programmed to either of two different directions: (1) tilted all the way forward, or (2) tilted all the way backward. The programming procedure changes the direction that the slats are programmed. In other words, if the slats previously had a Closed Position that tilted the slats all the way forward, the new Closed Position will tilt the slats all the way backward.

PROGRAMMING (CHANGING) THE CLOSED POSITION

PROCEDURE FOR CHANGING THE CLOSED POSITION



**HOLD FOR
TEN SECONDS**

Press the bottom of the switch for ten seconds. The slats may move while you continue to press the switch. Continue to press for a full ten seconds.

When you release the blinds will wiggle. The wiggle indicates that the new Closed Position has been successfully programmed (if the slats previously tilted forward upon closing, they will now tilt forward upon closing, or vice versa).